

M25 Bell Common Tunnel Refurbishment



Eamonn Colgan
Highways Agency Project
Manager

Steve Meadowcroft
Costain project director

M25 Bell Common Tunnel Refurbishment



One of the busiest tunnels in Europe carrying 120,000 vehicles a day

Close to the strategic J27 with the M11

M25 Bell Common Tunnel Refurbishment

Introduction

Major Maintenance Scheme costing £90m a significant investment to upgrade the tunnel.

Works starting in October 2008 lasting about 18 months with completion in early 2010.

Main Contractor Costain who has recently successfully completed Holmesdale Tunnel refurbishment, M27 widening and A2/A282.

To minimise the inconvenience we will be working on a 24/7 basis

M25 Bell Common Tunnel Refurbishment

Traffic Management Arrangements

During the day three lanes will be available in each direction. At night when traffic flows are lighter the number of lanes will be reduced.

There will be narrow lanes and the hard shoulder will be used for a running lane.

There will be 24/7 monitoring and a free recovery service

In the first stage there will be a temporary speed limit of 50 mph this will be reduced to 40 mph when the traffic is in contra flow.

M25 Bell Common Tunnel Refurbishment

Avoiding Delays

We anticipate that there will be 10–20 minutes delay at peak times on the M25. (Similar to Holmesdale refurbishment)

There will be no closures of slip roads

We do not anticipate that there will be any significant increase in traffic using local roads

Westbound Entry



What are the improvements?

- Upgrade tunnel equipment in line with new standards
- Full replacement of mechanical and electrical plant
- Removal of raised walkways
- Passive fire protection of structure
- Additional operational safety mitigation measures
- Make provision for future 4 lane Widening Scheme

Proposed Ventilation Fan Station



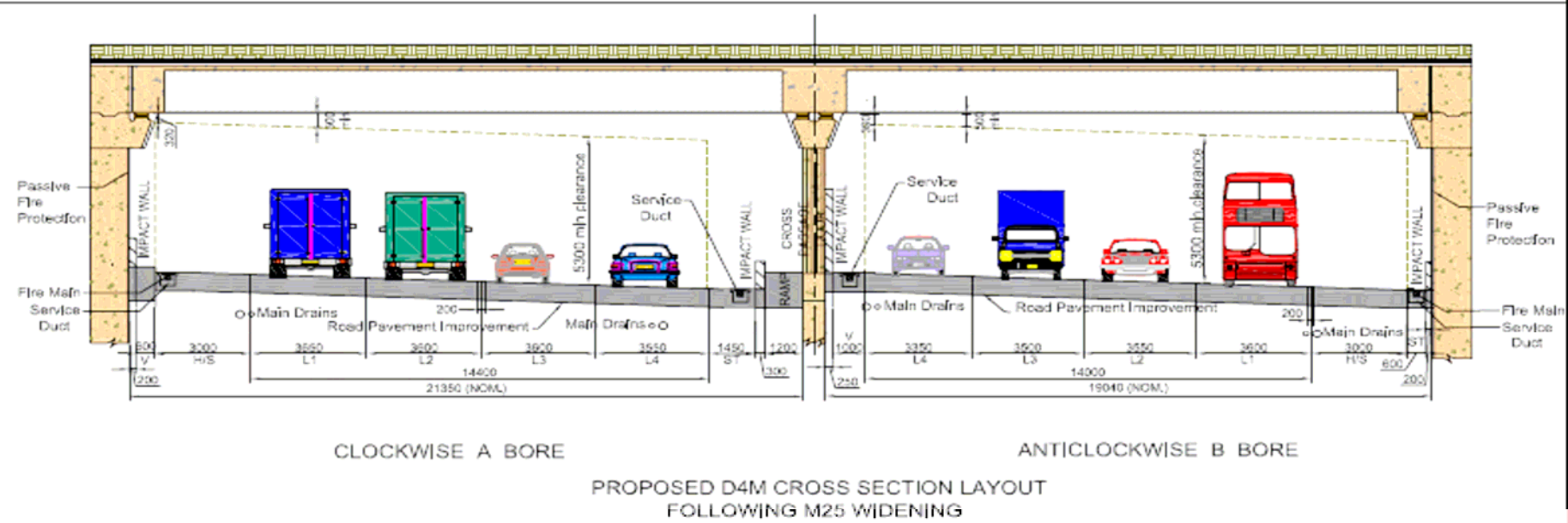
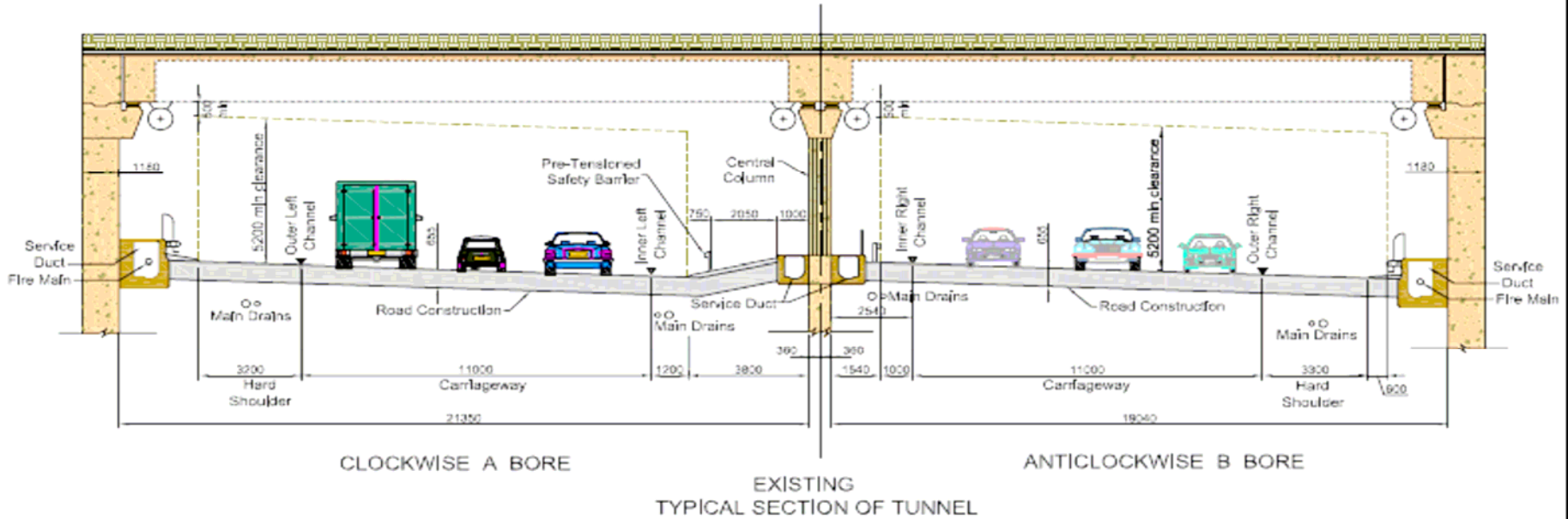

M25 Bell Common Tunnel Refurbishment

Informing Stakeholders

- **Strategic Signing**
- **publicity media** at service areas & airports for long distance traffic warning of possible delays
- **local exhibitions**
- **Discussions** with Local Highway Authorities and stakeholders
- **Website** –
www.highways.gov.uk/m25bellcommontunnel

M25 Bell Common Tunnel Refurbishment

Contacting the Project Team on site

Telephone 08456 037 985

E mail bcinfo@costain.com

Post Community Relations Manager

Bell Common Tunnel Project

Site Compound

Great Cambridge Road

Waltham Cross

Enfield Middlesex EN8 8EX

M25 Bell Common Tunnel Refurbishment

Where can I get more information?

- **Start of works exhibitions Quality Hotel Epping Friday 3 and Saturday 4 October**
- **www.highways.gov.uk/m25bellcommontunnel**
- **Traffic radio available on DAB digital radio and the internet at www.trafficradio.org.uk**
- **Live traffic information 08700 660115**
- **Question or comment ? 08457 50 40 30**
- **Or e mail ha-info@highways.gsi.gov.uk**

Safety at roadworks



The Highways Agency is working with the industry and road users to reduce the risks of working on the roads.

For the safety of roadworkers and all road users, when you are approaching roadworks:

- Keep within the speed limit – it is there for your safety.
- Get into the correct lane in good time – don't keep switching.
- Concentrate on the road ahead, not the roadworks.
- Be alert for works traffic leaving or entering roadworks.
- Keep a safe distance – there could be queues in front.
- Observe all signs – they are there to help you.